

Base connector A

Form A · 3 or 4-poles

DIN 43 650 / EN 175301 - 803

| | |
|-------------------|---------------------|
| Contact spacing | 18 mm |
| Rated voltage | 250VAC / 300 VDC |
| Operating current | 10 A |
| Max. current | 16 A |
| Max. wire gauge | 1,0 mm ² |
| Termination | solder |
| Housing material | PA + 30 % GF |
| Contact material | Cu Zn (Ag) |
| Temperature range | -40° C ... + 125° C |

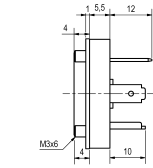
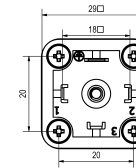
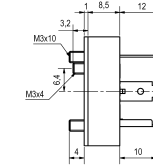
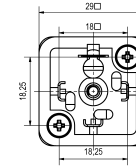
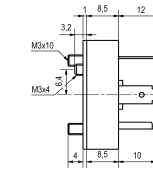
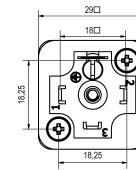
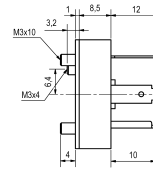
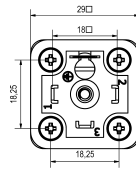

| Mounting | Part No. | Part No. | Special Feature |
|---------------|----------|----------|-----------------|
| | 2+PE | 3+PE | |
| M3x10 mm (2x) | B282-H | B283-H | PE-screw |
| M3x10 mm (2x) | B262-H | B263-H | PE-screw |
| M3x10 mm (4x) | B262-T | B263-T | PE-screw |
| M3x7 mm (4x) | B282-HY | B283-HY | round collar |

Specifications are subject to change without notice, scale drawings on request

TEL:021-36374188 FAX:021-51062637 Email:shkente@126.com

Base connector A

Form A · 3 or 4-poles

DIN 43 650 / EN 175301 - 803

| | |
|-------------------|---------------------|
| Contact spacing | 18 mm |
| Rated voltage | 250VAC / 300 VDC |
| Operating current | 10 A |
| Max. current | 16 A |
| Max. wire gauge | 1,0 mm ² |
| Termination | solder |
| Housing material | PA + 30 % GF |
| Contact material | Cu Zn (Ag) |
| Temperature range | -40° C ... + 125° C |

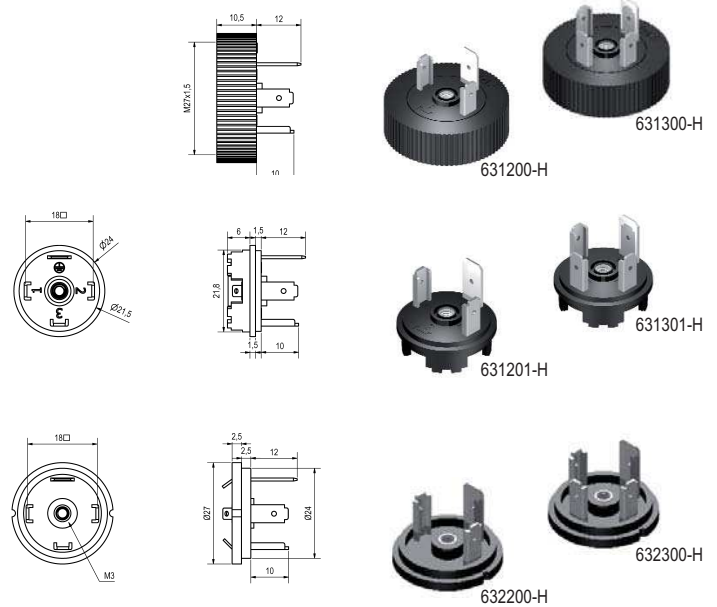

| Mounting | Part No. | Part No. | Special Feature |
|--------------|----------|----------|-------------------|
| | 2+PE | 3+PE | |
| Ø 24,5/22 mm | 631200-H | 631300-H | M27 x 1.5 locking |
| Ø 24,5/22 mm | 631201-H | 631301-H | |
| Ø 27/24 mm | 632200-H | 632300-H | |

Specifications are subject to change without notice, scale drawings on request

Base connector B Form B

Industrial

| | |
|-------------------|---------------------|
| Contact spacing | 11 mm |
| Rated voltage | 250VAC / 300 VDC |
| Operating current | 10 A |
| Max. current | 16 A |
| Max. wire gauge | 1,0 mm ² |
| Termination | solder |
| Housing material | PA + 30 % GF |
| Contact material | Cu Zn (Ag) |
| Temperature range | -40° C ... + 125° C |

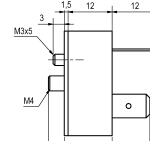
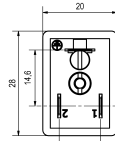

B272-H

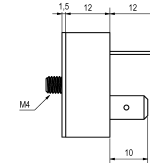
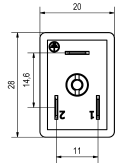

B274-H

| Mounting | Contacts | Part No. | Special Feature |
|--------------|----------|----------|----------------------|
| M4 x 15,5 mm | 2 + PE | B272-H | M3 x 5 mm PE - screw |
| M4 x 15,5 mm | 2 + PE | B274-H | without PE - screw |

Specifications are subject to change without notice, scale drawings on request

Base connector C
Form C

Industrial / DIN 43 650 / EN 175301 - 803

| | |
|-------------------|--------------------------------------|
| Contact spacing | 8 mm (DIN/EN) 9,4 mm (Industrial) |
| Rated voltage | 250 VAC / 300 VDC |
| Operating current | 6 A |
| Max. current | 10 A |
| Max. wire gauge | 0,75 mm ² |
| Termination | solder |
| Housing material | PA + 30 % GF |
| Contact material | Cu Zn (Ag) |
| Temperature range | -40° C ... + 125° C |

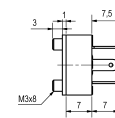
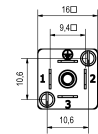
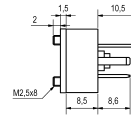
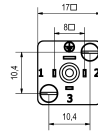

| Mounting | Contacts | Part No. | Part No. |
|------------|----------|---------------|---------------------|
| | | 8 mm (DIN/EN) | 9,4 mm (Industrial) |
| M2.5x8,5mm | 2+PE | B252-H | |
| M2.5x8,5mm | 3+PE | B253-H | |
| M3x8,5mm | 2+PE | | B292-H |
| M3x8,5mm | 3+PE | | B293-H |

Specifications are subject to change without notice, scale drawings on request